



# Versatile Jumbo Steel Coil Dispenser

## Model HD13



### Features

- Large Capacity Tower
- Multi-Coil Capacity  
Turntable for Decreased  
Downtime
- One-way Clutch  
Maintains Strap Tension  
on Coil Face
- Forklift Loading
- 4000 lb capacity
- 110 Volt Plug-in or  
System Hookup
- 3 Phase Gear Motor Drive
- Easy to use Load Hold  
Down Ring
- Clockwise and  
Counter-Clockwise Payoff

# Model HD13 Jumbo Steel Coil Dispenser

## Model HD13

The Samuel HD13 Jumbo Steel Coil Dispenser is designed for the demands of today's high output facilities. The large capacity turntable carries up to three coils, reducing downtime in your plant due to changeovers. With a heavy duty thrust bearing for smooth turntable rotation, and roller chain drive, the HD13 will keep your efficiency high and your packaging costs low.

## Construction

The HD13 features rugged structural steel frame construction which will withstand the demands of any plant environment. With a high torque 3 phase AC gear motor drive, and a high capacity linear bearing on the tower take-up carriage, this jumbo dispenser will deliver strap evenly to your unitizing equipment. UL and CSA approved electronics can be combined with your systems' shut off switch for maximum safety for plant personnel.

## General Specifications

Unit Height	91" (2310mm)
Unit Width	48" (1220mm)
Unit Length	92" (2337mm)

## Power Requirements

Voltage	110 volts single phase
Current	10 Amps

## Coil Data

Max Coil Weight	4000lbs (1800 kg)
Max Coil O.D.	36" (914mm)
Min. Coil I.D.	16" (406mm)
Max. Load Height	34" (864mm)

## Feed Rate & Accumulation

Max Table Speed at 60HZ	22 RPM
Recommended Jog Speed at 20HZ	7 RPM
Feed Rate at 36" Coil O.D.	207 FPM (63 M/min)
Feed Rate at 30" Coil O.D.	172 FPM (52 M/min)
Feed Rate at 16" Coil I.D.	92 FPM (28 M/min)
Max Tower Capacity	37' 8" (11.5m)

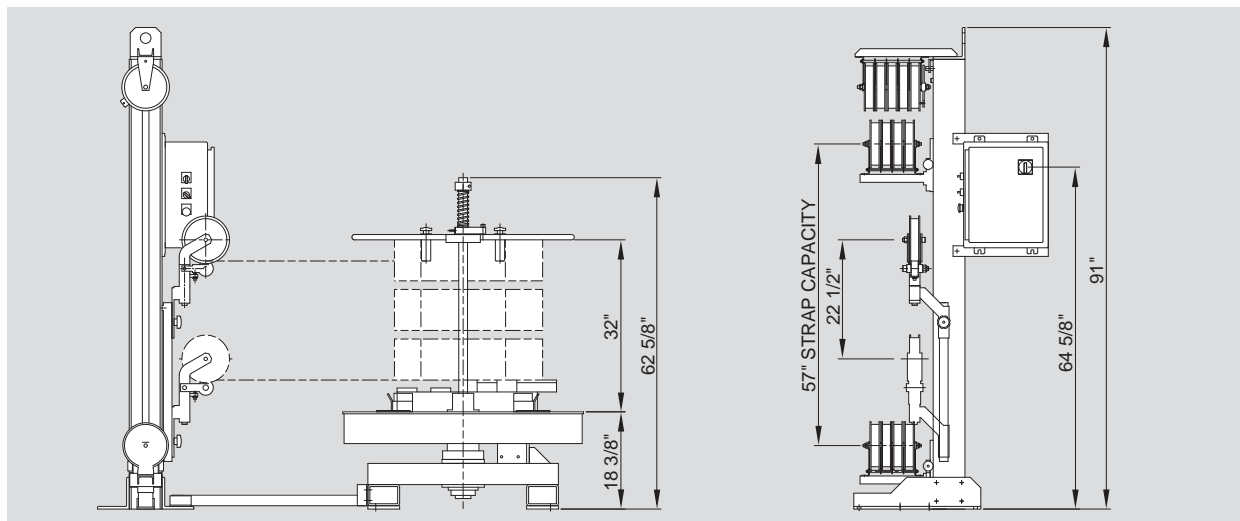
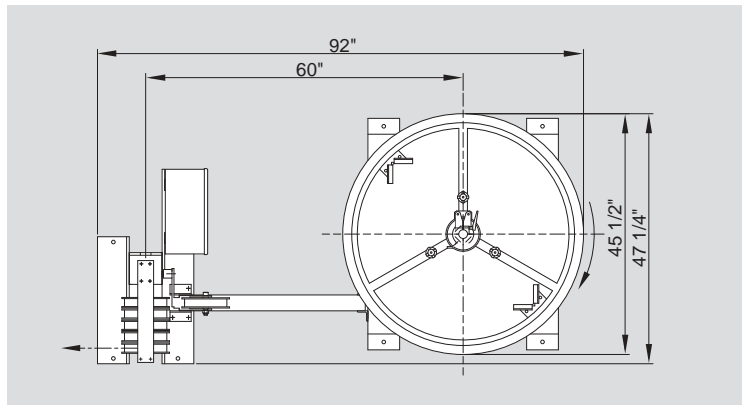

## Samuel Strapping Systems

U.S.A.  
1-800-323-4424

Canada  
1-800-607-8727

[www.samuelstrapping.com](http://www.samuelstrapping.com)